

**46 SERIES**

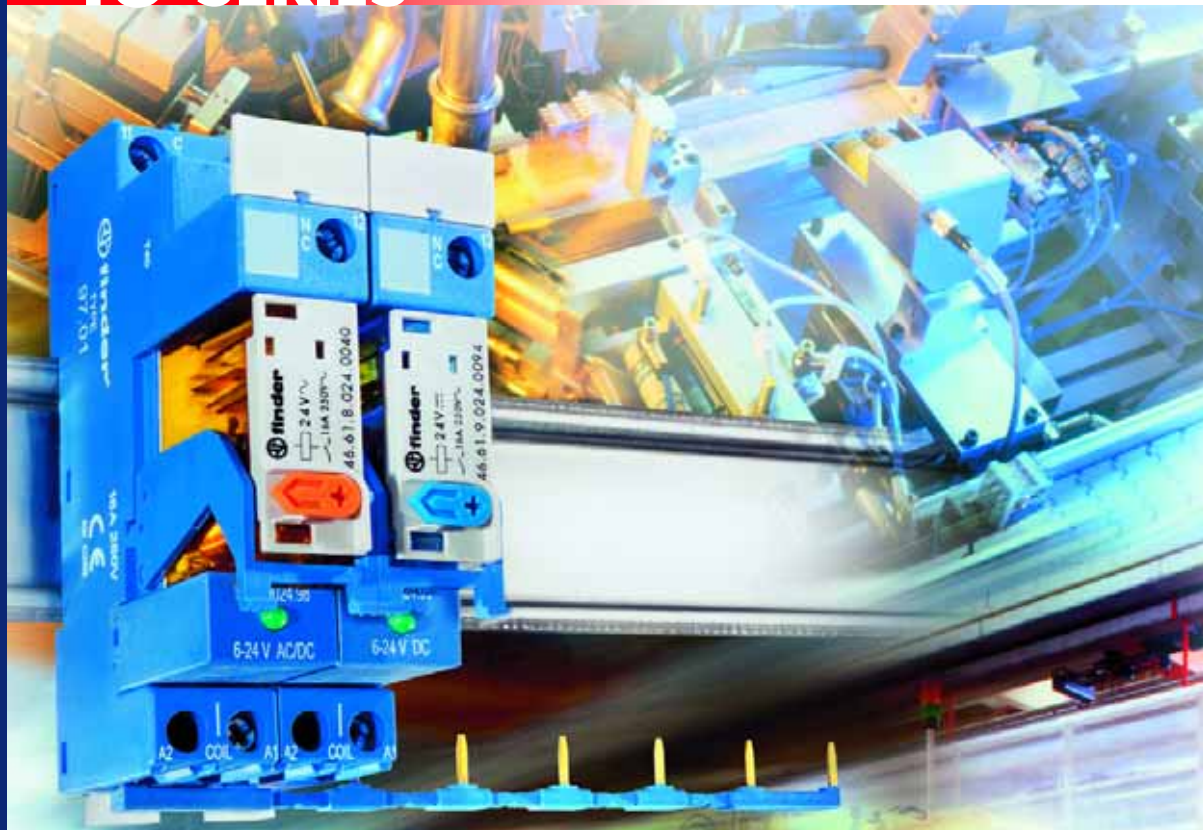

**NEW**

**Fast,  
Reliable and  
Secure Connections**



**Miniature industrial  
relays**

 **finder**<sup>®</sup>  
The power in relays and timers since 1954

## Features

**1 & 2 Pole relay range**  
**46.52 - 2 Pole 8 A**  
**46.61 - 1 Pole 16 A**

- Socket mount or direct connection via Faston connectors
- AC coils & DC coils
- Available with: lockable test button, mechanical indicator & LED indicator
- Reinforced insulation between coil and contacts according to EN 60335-1 (VDE 0700), with safe separation and 8 mm clearance and creepage distance
- Cadmium Free contacts

**46.52**



- 2 Pole changeover contacts
- Plug-in/Faston (2.5x0.5)mm

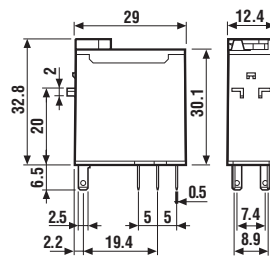
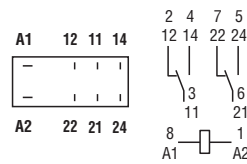

**46.61**

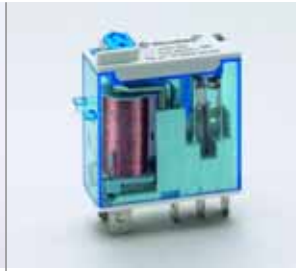

- 1 Pole changeover contact
- Plug-in/Faston 187

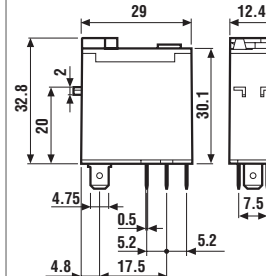
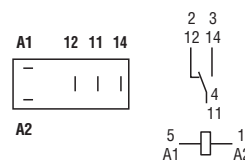

Contact specification			
Contact configuration		2 CO (DPDT)	1 CO (SPDT)
Rated current/Maximum peak current	A	8/15	16/25
Rated voltage/Maximum switching voltage	V AC	250/440	250/440
Rated load AC1	VA	2,000	4,000
Rated load AC15 (230 V AC)	VA	350	750
Single phase motor rating (230 V AC)	kW	0.37	0.55
Breaking capacity DC1: 30/110/220 V	A	6/0.3/0.12	12/0.5/0.15
Minimum switching load	mW (V/mA)	300 (5/5)	300 (5/5)
Standard contact material		AgNi	AgNi
Coil specification			
Nominal voltage (U <sub>N</sub> )	V AC (50/60 Hz)	12 - 24 - 48 - 110 - 120 - 230 - 240	
	V DC	12 - 24 - 48 - 110 - 125	
Rated power	VA/W	1.2/0.5	1.2/0.5
Operating range	AC	(0.8...1.1)U <sub>N</sub>	(0.8...1.1)U <sub>N</sub>
	DC	(0.73...1.1)U <sub>N</sub>	(0.73...1.1)U <sub>N</sub>
Holding voltage	AC/DC	0.8U <sub>N</sub> / 0.4U <sub>N</sub>	0.8U <sub>N</sub> / 0.4U <sub>N</sub>
Must drop-out voltage	AC/DC	0.2U <sub>N</sub> / 0.1U <sub>N</sub>	0.2U <sub>N</sub> / 0.1U <sub>N</sub>
Technical data			
Mechanical life AC/DC	cycles	10 · 10 <sup>6</sup>	10 · 10 <sup>6</sup>
Electrical life at rated load AC1	cycles	100 · 10 <sup>3</sup>	100 · 10 <sup>3</sup>
Operate/release time	ms	10/3	15/5
Insulation between coil and contacts (1.2/50 μs)	kV	6 (8 mm)	6 (8 mm)
Dielectric strength between open contacts	V AC	1,000	1,000
Ambient temperature range	°C	-40 ... +70	-40 ... +70
Environmental protection		RT II	RT II
Approvals (according to type)			

## Ordering information

Example: 46 series Miniature industrial relay, 1 CO (SPDT), 24 V DC coil, lockable test button and mechanical indicator.

	<b>4 6</b>	<b>. 6</b>	<b>1 . 9 .</b>	<b>0 2 4 .</b>	<b>A</b>	<b>B</b>	<b>C</b>	<b>D</b>	
<p><b>Series</b> _____</p> <p><b>Type</b> _____</p> <p>5 = Spade/blade terminal Faston (2.5x0.5)mm</p> <p>6 = Spade/blade terminal Faston 187 (4.8x0.5)mm</p> <p><b>No. of poles</b> _____</p> <p>1 = 1 pole, 16 A</p> <p>2 = 2 poles, 8 A</p> <p><b>Coil version</b> _____</p> <p>9 = DC</p> <p>8 = AC (50/60 Hz)</p> <p><b>Coil voltage</b> _____</p> <p>see coil specifications</p>					<p><b>A: Contact material</b></p> <p>0 = AgNi</p> <p><b>B: Contact circuit</b></p> <p>0 = CO (nPDT)</p>				<p><b>D: Special versions</b></p> <p>0 = Standard</p> <p><b>C: Options</b></p> <p>2 = Mechanical indicator</p> <p>4 = Lockable test button + mechanical indicator</p> <p>54 = Lockable test button + LED (AC) + mechanical indicator</p> <p>74 = Lockable test button + double LED (DC non-polarized) + mechanical indicator</p>

**Selecting features and options: only combinations in the same row are possible.**  
Preferred selections for best availability are shown in **bold**.

Type	coil version	A	B	C	D
46.52/61	AC-DC	<b>0</b>	<b>0</b>	2 - <b>4</b>	<b>0</b>
46.52/61	AC	0	0	54	/
46.52/61	DC	0	0	74	/

### Descriptions: Options

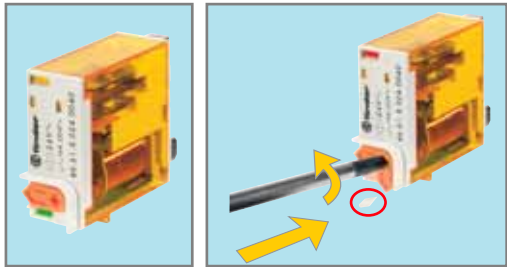
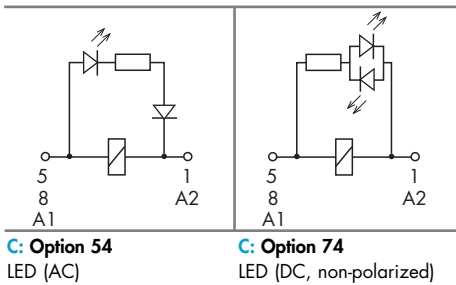

### Lockable test button and mechanical flag indicator (0040, 0054, 0074)

The dual-purpose Finder test button can be used in two ways:

Case 1) The plastic pip (located directly below the test button) remains intact. In this case, when the test button is pushed, the contacts operate. When the test button is released the contacts return to their former state.

Case 2) The plastic pip is broken-off (using an appropriate cutting tool). In this case, (in addition to the above function), when the test button is pushed and rotated, the contacts are latched in the operating state, and remain so until the test button is rotated back to its former position.

In both cases ensure that the test button actuation is swift and decisive.

## Technical data

Insulation			
Insulation according to EN 61810-1 ed. 2	insulation rated voltage	V	250
	rated impulse withstand voltage	kV	4
	pollution degree		3
	overvoltage category		III
Insulation between coil and contacts (1.2/50 μs)		kV	6 (8 mm)
Dielectric strength between open contacts		V AC	1,000
Dielectric strength between adjacent contacts		V AC	2,000
Conducted disturbance immunity			
Burst (5...50)ns, 5 kHz, on A1 - A2			EN 61000-4-4
Surge (1.2/50 μs) on A1 - A2 (differential mode)			EN 61000-4-5
<b>Other data</b>			<b>1 changeover contact</b>
Bounce time: NO/NC		ms	2/6
Power lost to the environment	without contact current	W	0.6
	with rated current	W	1.6
			<b>2 changeover contacts</b>
			1/4
			0.6
			2

## Contact specification

**F 46 - Electrical life (AC) v contact current**  
Type 46.52

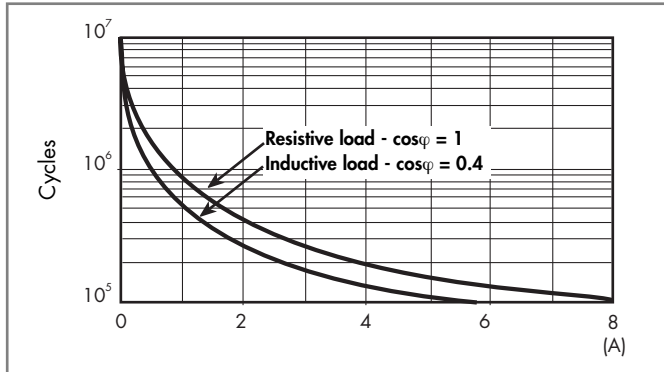

**F 46 - Electrical life (AC) v contact current**  
Type 46.61

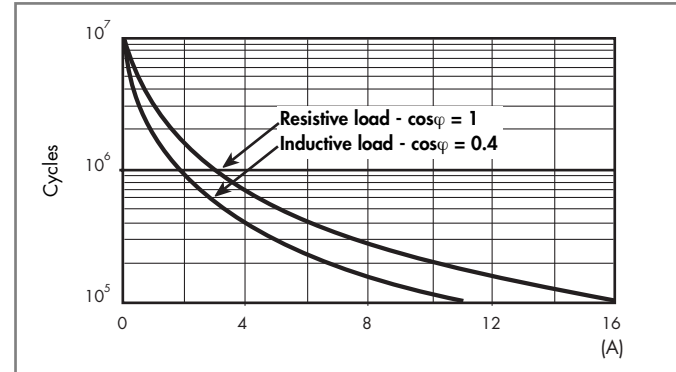

**H 46 - Maximum DC1 breaking capacity**

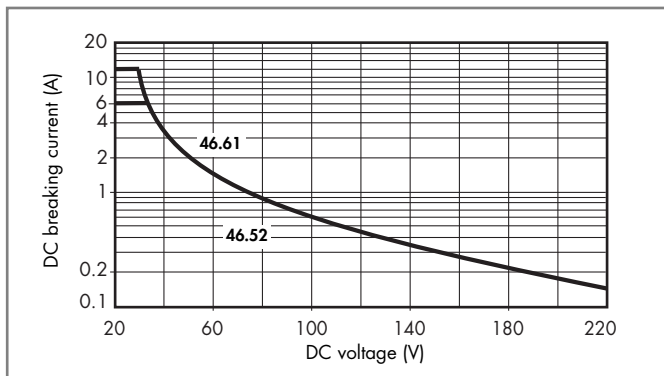

- When switching a resistive load (DC1) having voltage and current values under the curve, an electrical life of  $\geq 100 \cdot 10^3$  can be expected.
- In the case of DC13 loads, the connection of a diode in parallel with the load will permit a similar electrical life as for a DC1 load. Note: the release time for the load will be increased.

## Coil specifications

**DC coil data**

Nominal voltage $U_N$ V	Coil code	Operating range		Resistance R $\Omega$	Rated coil consumption I at $U_N$ mA
		$U_{min}$ V	$U_{max}$ V		
12	9.012	8.8	13.2	300	40
24	9.024	17.5	26.4	1,200	20
48	9.048	35	52.8	4,800	10
110	9.110	80	121	23,500	4.7
125	9.125	91.2	137.5	32,000	3.9

**AC coil data**

Nominal voltage $U_N$ V	Coil code	Operating range		Resistance R $\Omega$	Rated coil consumption I at $U_N$ mA
		$U_{min}$ V	$U_{max}$ V		
12	8.012	9.6	13.2	80	90
24	8.024	19.2	26.4	320	45
48	8.048	38.4	52.8	1,350	21
110	8.110	88	121	6,900	9.4
120	8.120	96	132	9,000	8.4
230	8.230	184	253	28,000	5
240	8.240	192	264	31,500	4.1

**R 46 - DC coil operating range v ambient temperature**

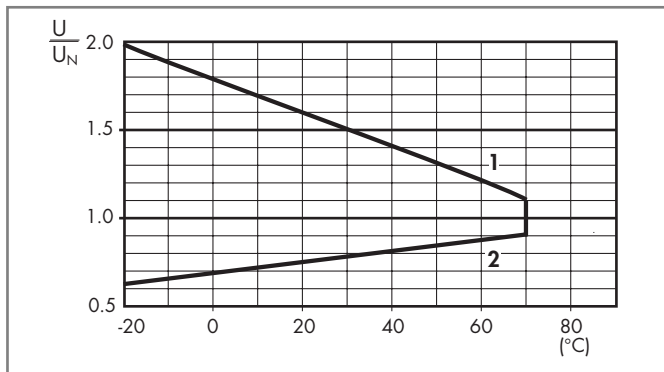

- 1 - Max. permitted coil voltage.  
2 - Min. pick-up voltage with coil at ambient temperature.

**R 46 - AC coil operating range v ambient temperature**

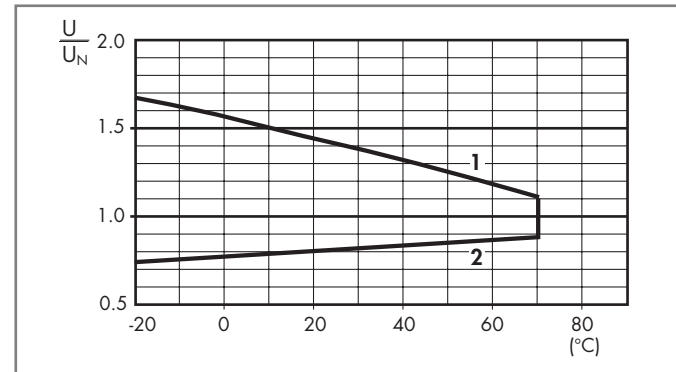

- 1 - Max. permitted coil voltage.  
2 - Min. pick-up voltage with coil at ambient temperature.

## Accessories



046.05



046.05 with relay

**Flange mount adaptor** for relays types 46.52 and 46.61

046.05

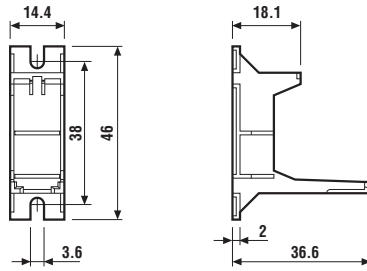

046.07



046.07 with relay

**35 mm rail adaptor** for relays types 46.52 and 46.61

046.07

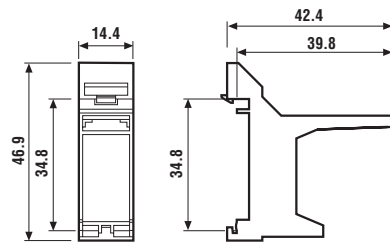

060.72

**Sheet of marker tags** for relays types 46.52 and 46.61 (72 tags), 6x12mm

060.72





97.01

Approvals  
(according to type):



097.01

Screw terminal socket panel or 35 mm rail (EN 50022) mount	97.01 (blue)	97.02 (blue)
For relay type	46.61	46.52
<b>Accessories</b>		
Plastic retain and eject clip (supplied with socket - packaging code SPA)		097.01
Identification tag		095.00.4
8-way jumper link		095.18
Modules (see table below)		99.02
Timer modules (see table below)		86.10, 86.20
<b>Technical data</b>		
Rated current	16 A - 250 V AC	8 A - 250 V AC
Dielectric strength	≥ 6 kV (1.2/50 μs) between coil and contacts	
Protection category	IP 20	
Ambient temperature	°C -40...+70 (see diagram L97)	
Screw torque	Nm 0.8	
Wire strip length	mm 8	
Max. wire size for 97.01 and 97.02 sockets	solid wire	stranded wire
	mm <sup>2</sup>	1x6 / 2x2.5
	AWG	1x10 / 2x14

### L 97 - Rated current vs ambient temperature

(for 46.61 relay / 97.01 socket combination)

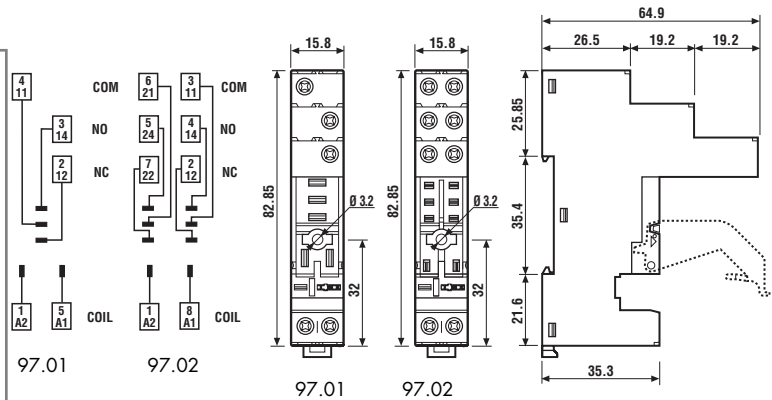
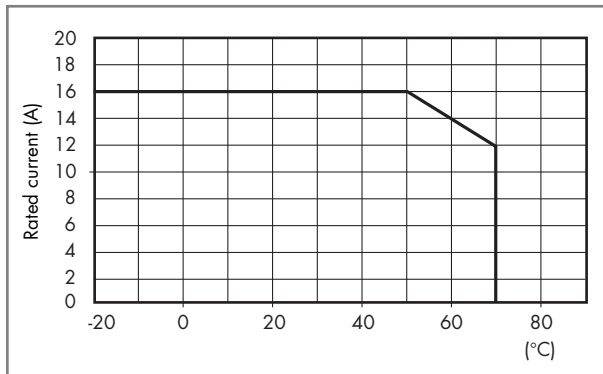

095.18

<b>8-way jumper link for 97.01 and 97.02 sockets</b>	095.18
Rated values	10 A - 250 V

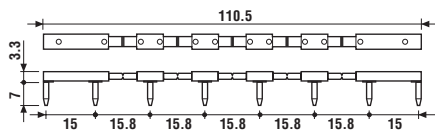

86.10

<b>86 series timer modules</b>	Blue
Mono-function: (12...24)V AC/DC; function AI; (1.5s...60min)	86.10.0.024.0000
Mono-function: (12...24)V AC/DC; function DI; (1.5s...60min)	86.20.0.024.0000

Approvals  
(according to type):



99.02

Approvals  
(according to type):



<b>99.02 coil indication and EMC suppression modules for 97.01 and 97.02 sockets</b>		Blue*
Diode (+A1, standard polarity)	(6...220)V DC	99.02.3.000.00
LED	(6...24)V DC/AC	99.02.0.024.59
LED	(28...60)V DC/AC	99.02.0.060.59
LED	(110...240)V DC/AC	99.02.0.230.59
LED + Diode (+A1, standard polarity)	(6...24)V DC	99.02.9.024.99
LED + Diode (+A1, standard polarity)	(28...60)V DC	99.02.9.060.99
LED + Diode (+A1, standard polarity)	(110...220)V DC	99.02.9.220.99
LED + Varistor	(6...24)V DC/AC	99.02.0.024.98
LED + Varistor	(28...60)V DC/AC	99.02.0.060.98
LED + Varistor	(110...240)V DC/AC	99.02.0.230.98
RC circuit	(6...24)V DC/AC	99.02.0.024.09
RC circuit	(28...60)V DC/AC	99.02.0.060.09
RC circuit	(110...240)V DC/AC	99.02.0.230.09
Residual current by-pass (62 kΩ/1W)	(110...240)V AC	99.02.8.230.07

\* Modules in Black housing are available on request.



97.51

Approvals  
(according to type):



097.01

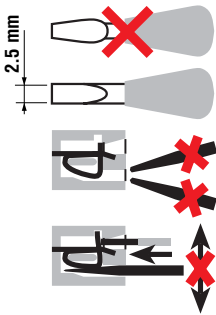

<b>Screwless terminal socket</b> panel or 35 mm rail (EN 50022) mount	<b>97.51 (blue)</b>	<b>97.52 (blue)</b>
For relay type	46.61	46.52
<b>Accessories</b>		
Plastic retain and eject clip (supplied with socket - packaging code SPA)	097.01	
Modules (see table below)	99.02	
Timer modules (see table below)	86.10, 86.20	
<b>Technical data</b>		
Rated current	12 A - 250 V AC	8 A - 250 V AC
Dielectric strength	≥ 6 kV (1.2/50 μs) between coil and contacts	
Protection category	IP 20	
Ambient temperature	°C -25...+70	
Wire strip length	mm 8	
Max. wire size for 97.51 and 97.52 sockets	solid wire	stranded wire
	mm <sup>2</sup> 2x(0.2...1.5)	2x(0.2...1.5)
	AWG 2x(24...18)	2x(24...18)

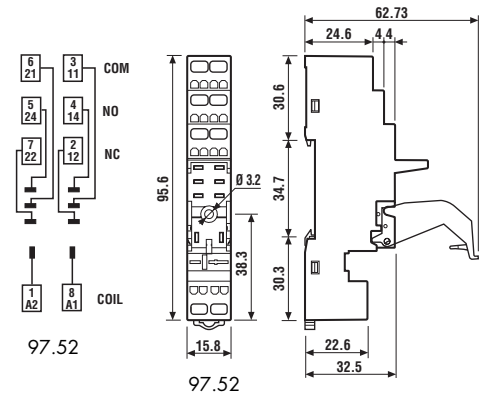
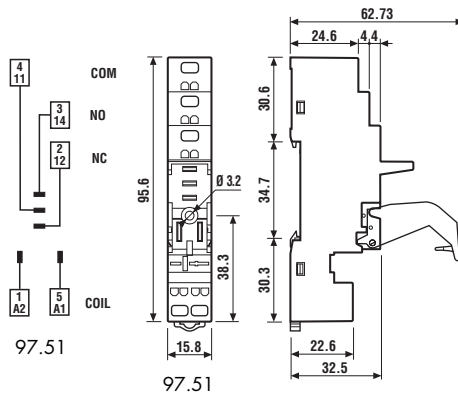

86.10

<b>86 series timer modules</b>	Blue
Mono-function: (12...24)V AC/DC; function AI; (1.5s...60min)	86.10.0.024.0000
Mono-function: (12...24)V AC/DC; function DI; (1.5s...60min)	86.20.0.024.0000

Approvals  
(according to type):



99.02

Approvals  
(according to type):



<b>99.02 coil indication and EMC suppression modules</b> for 97.51 and 97.52 sockets	Blue*	
Diode (+A1, standard polarity)	(6...220)V DC	99.02.3.000.00
LED	(6...24)V DC/AC	99.02.0.024.59
LED	(28...60)V DC/AC	99.02.0.060.59
LED	(110...240)V DC/AC	99.02.0.230.59
LED + Diode (+A1, standard polarity)	(6...24)V DC	99.02.9.024.99
LED + Diode (+A1, standard polarity)	(28...60)V DC	99.02.9.060.99
LED + Diode (+A1, standard polarity)	(110...220)V DC	99.02.9.220.99
LED + Varistor	(6...24)V DC/AC	99.02.0.024.98
LED + Varistor	(28...60)V DC/AC	99.02.0.060.98
LED + Varistor	(110...240)V DC/AC	99.02.0.230.98
RC circuit	(6...24)V DC/AC	99.02.0.024.09
RC circuit	(28...60)V DC/AC	99.02.0.060.09
RC circuit	(110...240)V DC/AC	99.02.0.230.09
Residual current by-pass (62 kΩ/1W)	(110...240)V AC	99.02.8.230.07

## Packaging codes

How to code and identify retaining clip and packaging options for sockets.

Code options according to the last three letters:

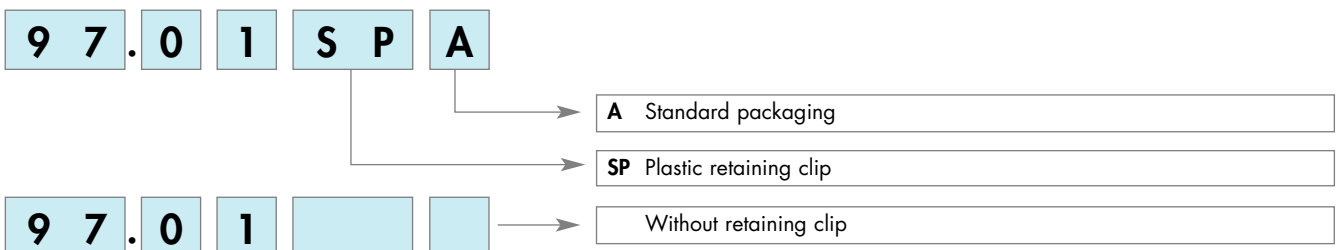



**FINDER FRANCE Sarl**  
Avenue d'Italie - BP 40  
Zone Ind. du Pré de la Garde  
F - 73302 ST. JEAN DE MAURIENNE Cédex  
Tel. +33/479/83 27 27  
Fax +33/479/59 80 04  
**Finder.fr@findernet.fr**



**FINDER GmbH**  
Eisenstrasse 30  
D - 65428 RÜSSELSHEIM  
Tel. +49/6142/8770  
Fax +49/6142/87777  
**finder.de@findernet.de**



**FINDER RELAYS, INC.**  
4465 Commerce Drive, Suite: 103  
Buford, GA 30518 - U.S.A.  
Tel. +1/770/271-4431  
Fax +1/770/271-7530  
**Finder.us@findernet.com**



**S.P.R.L. FINDER BELGIUM B.V.B.A.**  
Bloemendael, 5  
B - 1547 BEVER  
Tel. +32/54/30 08 68  
Fax +32/54/30 08 67  
**Finder.be@findernet.com**



**FINDER RELAIS NEDERLAND B.V.**  
Dukdalfweg 51  
NL - 1041 BC AMSTERDAM  
Tel. +31/20/615 65 57  
Fax +31/20/617 89 92  
**Finder.nl@findernet.com**



**FINDER COMPONENTES LTDA.**  
Rua Olavo Bilac, 326  
Bairro Santo Antonio  
São Caetano do Sul - SÃO PAULO  
CEP 09530-260 - BRASIL  
Tel. +55/11/2147 1550  
Fax +55/11/2147 1590  
**Finder.br@findernet.com**



**FINDER PLC**  
Opal Way - Stone Business Park  
STONE, STAFFORDSHIRE,  
ST15 OSS - UK  
Tel. +44/1785/818100  
Fax +44/1785/815500  
**Finder.uk@findernet.com**



**FINDER RELAIS VERTRIEBS GmbH**  
Aspangbahnstraße 2  
A - 2361 LAXENBURG  
Tel. +43/2236/86 41 36 - 0  
Fax +43/2236/86 41 36 36  
**Finder.at@findernet.com**



**RELEVADORES FINDER, S.A. de C.V.**  
Boulevard Hermanos Serdan No. 337  
Local C, Col. Aquiles Serdan  
C.P. 72140  
Puebla, Pue. - MEXICO  
Tel. +52/222/2973197  
Fax +52/222/2973198  
**Finder.mx@findernet.com**



**FINDER AB**  
Stationsvägen, 1  
SE - 435 25 MÖLNLYCKE  
Tel. +46/31/88 00 99  
Fax +46/31/88 06 04  
**Finder.se@findernet.com**



**FINDER CZ, s.r.o.**  
Hostivařská 6/92  
CZ - 102 00 PRAHA 10  
Tel. +420/2 8688 9504  
Fax +420/2 8688 9505  
**Finder.cz@findernet.com**



**FINDER ECHIPAMENTE srl**  
Str. Lunii, 6  
400367 CLUJ-NAPOCA  
jud. CLUJ - ROMANIA  
Tel. +40 264 403 888  
Fax +40 264 403 889  
**Finder.ro@findernet.com**



**FINDER ELECTRICA S.L.**  
Pol. Ind. La Pobra L'Elia, s/n. Parcela Nº 4  
E - 46185 La Pobra de Vallbona (VALENCIA)  
Dirección Postal Aptdo 234  
Tel. +34-96 272 52 95  
Fax +34-96 275 02 50  
**Finder.es@findernet.com**



**FINDER - Hungary Kereskedelmi Kft.**  
1046 BUDAPEST  
Kiss Ernő u. 1-3  
Tel. +06/1-399-15-25  
Fax +06/1-399-15-27  
**Finder.hu@findernet.com**



**FINDER PORTUGAL, LDA**  
R. Antero de Quental  
Edifício Hermes Nº 221 R/C Sala 17  
P - 4455 - 586 - PERAFITA  
Tel. +351/22 99 42 900 - 1  
Fax +351/22 99 42 902  
**Finder.pt@findernet.com**



**FINDER (SCHWEIZ) AG**  
Industriestrasse, 1a, Postfach 23  
CH - 8157 DIELSDORF (ZH)  
Tel. +41/44/885 30 10  
Fax +41/44/885 30 20  
**Finder.ch@finder-relais.ch**

Relais industriel mini 16A 24VDC 1 CO embrochable/souder test+LED(DC)+indicateur

FINDER reserves the right to alter characteristics at any time without notice.

FINDER assumes no liability for damage to people or property, caused as a result of the wrong use or application of its products.