

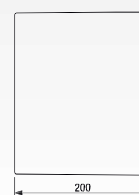

TECHNOLUX
SMART

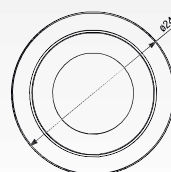

SMART DOWNLIGHT PERFORMER MW

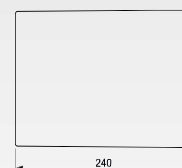
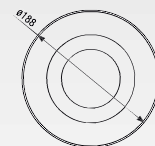
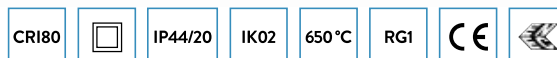

Downlight, non-orientable, muni du Bluetooth Low Energy (BLE)

CARACTERISTIQUES

- Matériau du boîtier : aluminium
- Couleur du boîtier : blanc (RAL 9003)
- Réflecteur : polycarbonate
- Tension : 220 - 240 V
- Température de service :
-10 °C + 40 °C
- Montage : à encastrer
- Diffuseur : polycarbonate
- Durée de vie : 60.000 h
- Driver compris

Référence	W	lm	K	Angle de rayonnement	UGR	Dimension d'encastrement ø mm	Profondeur d'encastrement mm	Dimensions ø (x L) x H mm	Remarque
401 SDPMW12W830W	11,5	1240	3000	70°	< 22	ø 150	58	ø 165 x 58	BLE (Bluetooth Low Energy)
401 SDPMW12W840W	11,5	1265	4000	70°	< 22	ø 150	58	ø 165 x 58	BLE (Bluetooth Low Energy)
401 SDPMW15W830W	15	1620	3000	70°	< 19	ø 200	73	ø 225 x 73	BLE (Bluetooth Low Energy)
401 SDPMW15W840W	15	1650	4000	70°	< 19	ø 200	73	ø 225 x 73	BLE (Bluetooth Low Energy)
401 SDPMW23W830W	23	2480	3000	70°	< 22	ø 200	73	ø 225 x 73	BLE (Bluetooth Low Energy)
401 SDPMW23W840W	23	2530	4000	70°	< 22	ø 200	73	ø 225 x 73	BLE (Bluetooth Low Energy)
401 SDPMW33W830W	33	3560	3000	70°	< 22	ø 200	73	ø 225 x 73	BLE (Bluetooth Low Energy)
401 SDPMW33W840W	33	3630	4000	70°	< 22	ø 200	73	ø 225 x 73	BLE (Bluetooth Low Energy)

ACCESSOIRES

Référence	Description
401 SDPRING150-175	Anneau 150 - 175 mm
401 SDPRING200-225	Anneau 200 - 225 mm
401 SDPRING200-250	Anneau 200 - 250 mm